

Connecting BDM-800 and Trunk Cable

Arrange Trunk Cable in portrait or landscape, add extension AC cable



Seal one end of trunk with an endcap*



Remove connector cover with an accessory tool



Unused connectors shall be sealed by a cap



Connect AC cable with a small screw driver

* For water tightness, the endcap is hard to be removed once installed.

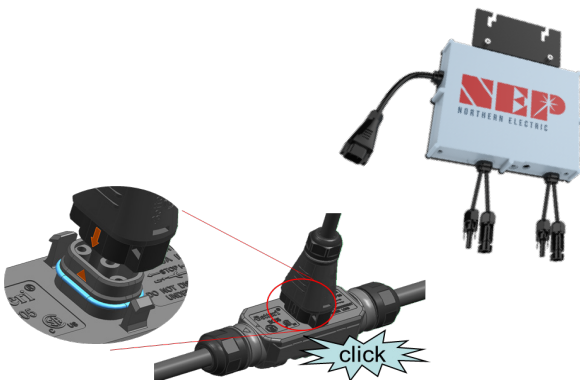

Connect BDM-800 to trunk cable

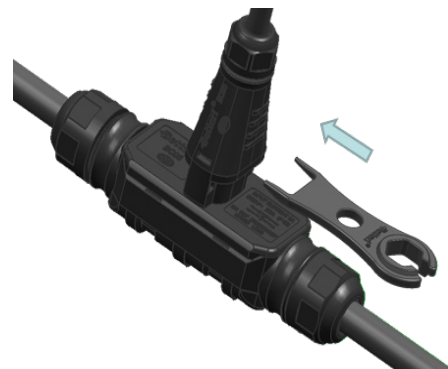

Disconnect BDM-800 from trunk cable